



Radius Series 4G

Product Manual

Register your Radius Series 4G speakers

Register your speakers using the QR code
or visit [monitoraudio.com/registration](https://www.monitoraudio.com/registration)



Welcome to Radius Series 4G

Thank you for purchasing this Radius Series 4G speaker, you're now ready to start your journey to breathtaking sound.

In this product manual, you'll find information about setting up your system and how to maintain your speakers for a lifetime of enjoyment.

If you need any further assistance, please contact our technical team at [monitoraudio.com/support](https://www.monitoraudio.com/support)

Contents

Unboxing	4
Feet, Desk Stand & Floor Stands	6
Setting up your system	8
Wiring your speakers	14
Using your speakers	15
Care & maintenance	16
Warranty	17
Specifications	18

Before you unpack your loudspeakers, please make sure that there is plenty of clean floor area available.

Radius 1, Radius 3 & On-Wall 4G

1. Open the top of the box.
2. Carefully tip the box upside down with the cardboard wings spread outwards.
3. Lift the box up to reveal the packed speakers and the box contents.
4. Remove the bottom end caps and any accessories.
5. Remove the protective bag from the speaker(s).

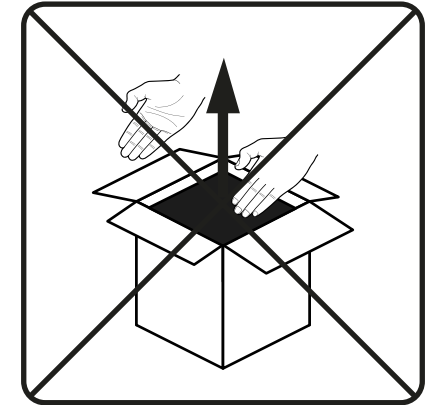
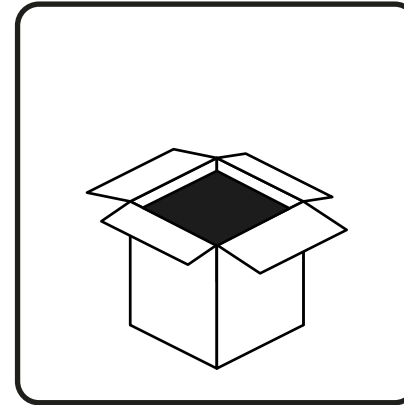

Radius 1 Configuration

The Radius 1 is handed, the preferred configuration for this is to have the tweeters on the outside of the setup.

The below diagram shows this configuration.

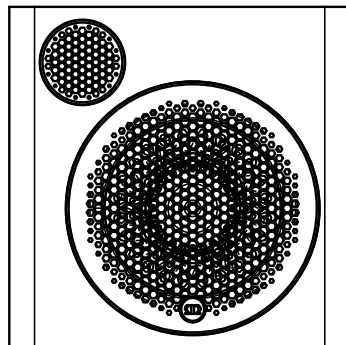
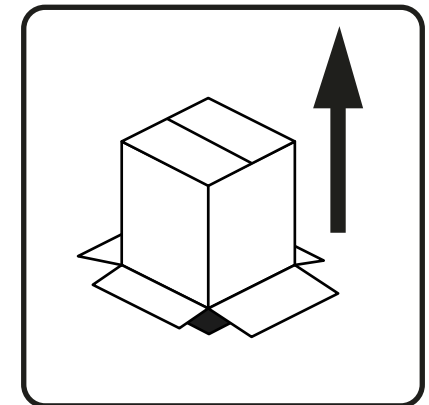
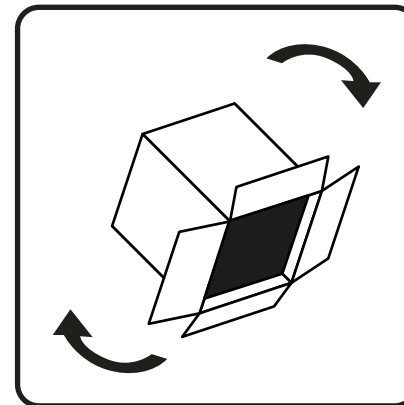

Left Speaker

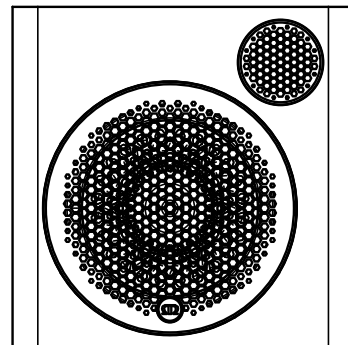

Right Speaker

Bump Feet

All Radius 4G speakers are supplied with self adhesive rubber bump feet. For the Radius 1 and Radius 3 4G, these should be applied to the underside of the cabinet when placing the speakers on a shelf or when using third party stands.

For the Radius On-Wall 4G, the bump feet should be applied to the rear surface that contacts the wall when the speaker is mounted and the cables are routed inside the wall. If the cables are not installed within the wall, use the supplied cable spacers instead.

The bump feet protect the cabinet finish, provides a degree of isolation, and reduces the likelihood of the speaker shifting in position.

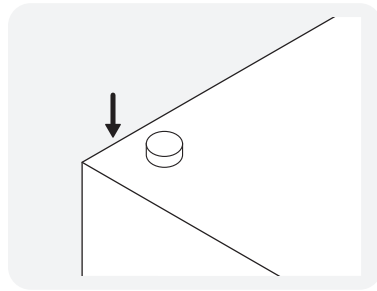

Desk Pad (Sold Separately)

Radius 1 and Radius 3 4G speakers can be used with the Radius Desk Pad 4G (sold separately). Place the Desk Pad 4G flat on the surface and position the speaker so that the rear of the cabinet rests against the raised bump (i), centred on the pad. There is a locator on the centre of the pad to line up with the speaker (ii).

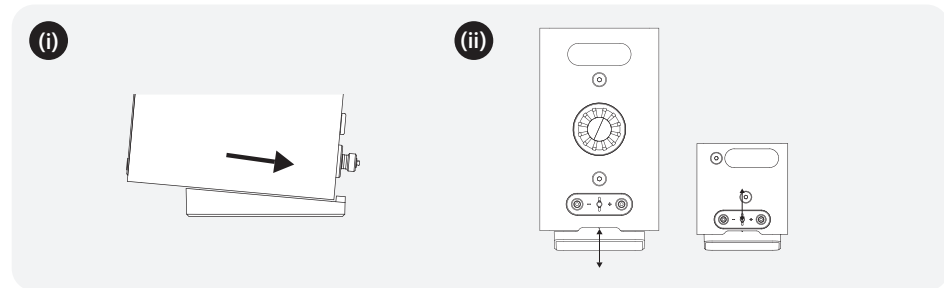

Floor Stand (Sold Separately)

Radius 1 and Radius 3 4G speakers can be stand-mounted with the Radius Floor Stand 4G (sold separately). Follow the below steps to install your speakers to the stand.

1. Attach the stand's feet to the main pole assembly.

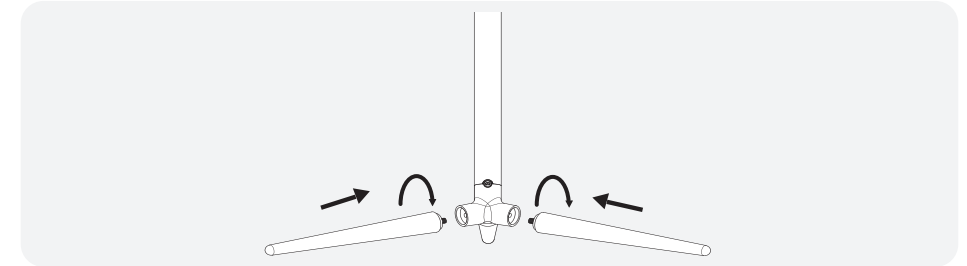

2. Secure the speaker using the threaded insert (1/4" UNC) on the rear of the cabinet using the supplied allen key. The bolt is captive in the stand.

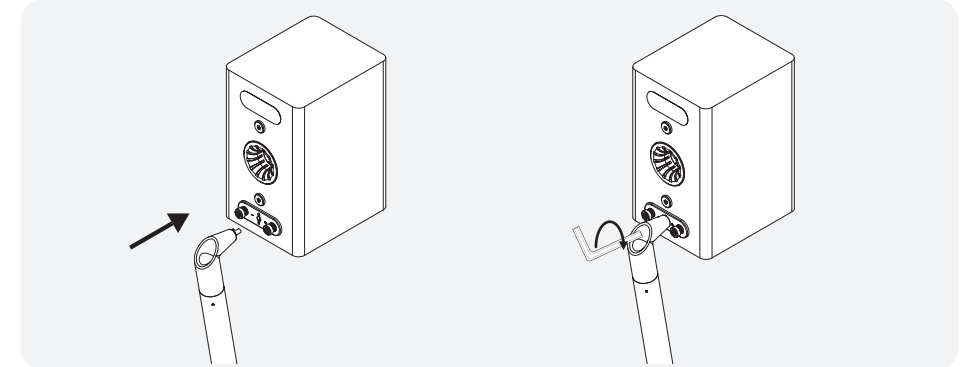

3. Speaker cable can be routed internally through the stand. Feed the speaker cable into the opening at the top of the pole and it will exit at the base for a clean, unobtrusive installation.

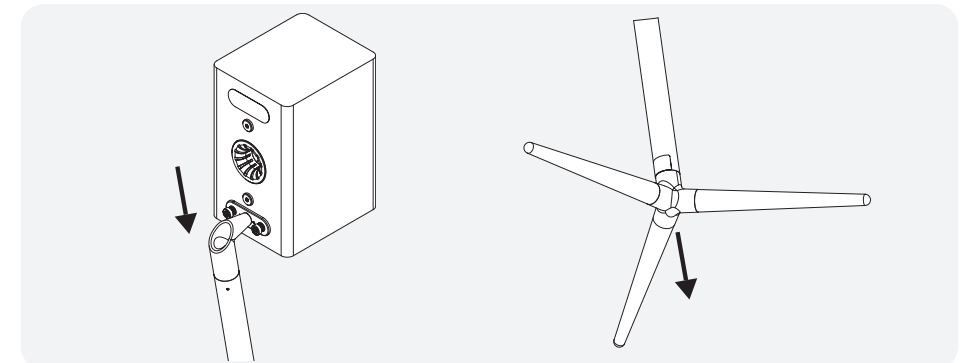

2 channel system

When arranging a 2 channel system, the listening position and the loudspeakers should form an equilateral triangle. Ideally the loudspeakers should be positioned approximately 6 - 10 feet (1.8 - 3m) apart and a minimum of 3 feet (91cm) from the side walls. When used with stands or desk pads, we would recommend the below minimum distances from the rear wall.

Radius 1	5 - 20 cm / 2 - 8 "
Radius 3	10 - 30 cm / 4 - 12 "

NOTE: These are recommended distances for optimal performance. Actual results will vary dependant on room size, construction and personal tastes.

Experimentation is strongly advised when setting up the loudspeakers, as environment and personal preference will differ with every installation.

For example, if there is insufficient bass for example, try moving your loudspeakers closer to the rear wall. The opposite approach is recommended if there is excessive bass. Additionally refer to the information relating to port bungs on page 15.

If stereo imaging is being lost, try 'toeing' them in slightly. Sounds that are recorded equally to each channel should sound as though they come from between the speakers. The angle should be adjusted to personal tastes, the speakers are designed to be pointed to a point behind the listener. For a more airy sound, point the speakers directly towards the listening position or to reduce this point them direct forward.

When using a subwoofer with the speakers in a 2.1 system, the subwoofer should be sited in the most suitable position, preferably not directly in the corner of a room as this may cause excessive bass boom. Once a desirable position is achieved it is important to check if the cables are long enough to reach comfortably without being under tension. The RCA inputs cables should be less than 10 metres to avoid interference.

If the subwoofer is rear ported it may need more room at the rear to prevent excessive bass boom. If the room isn't getting excited enough, then it can be moved closer.

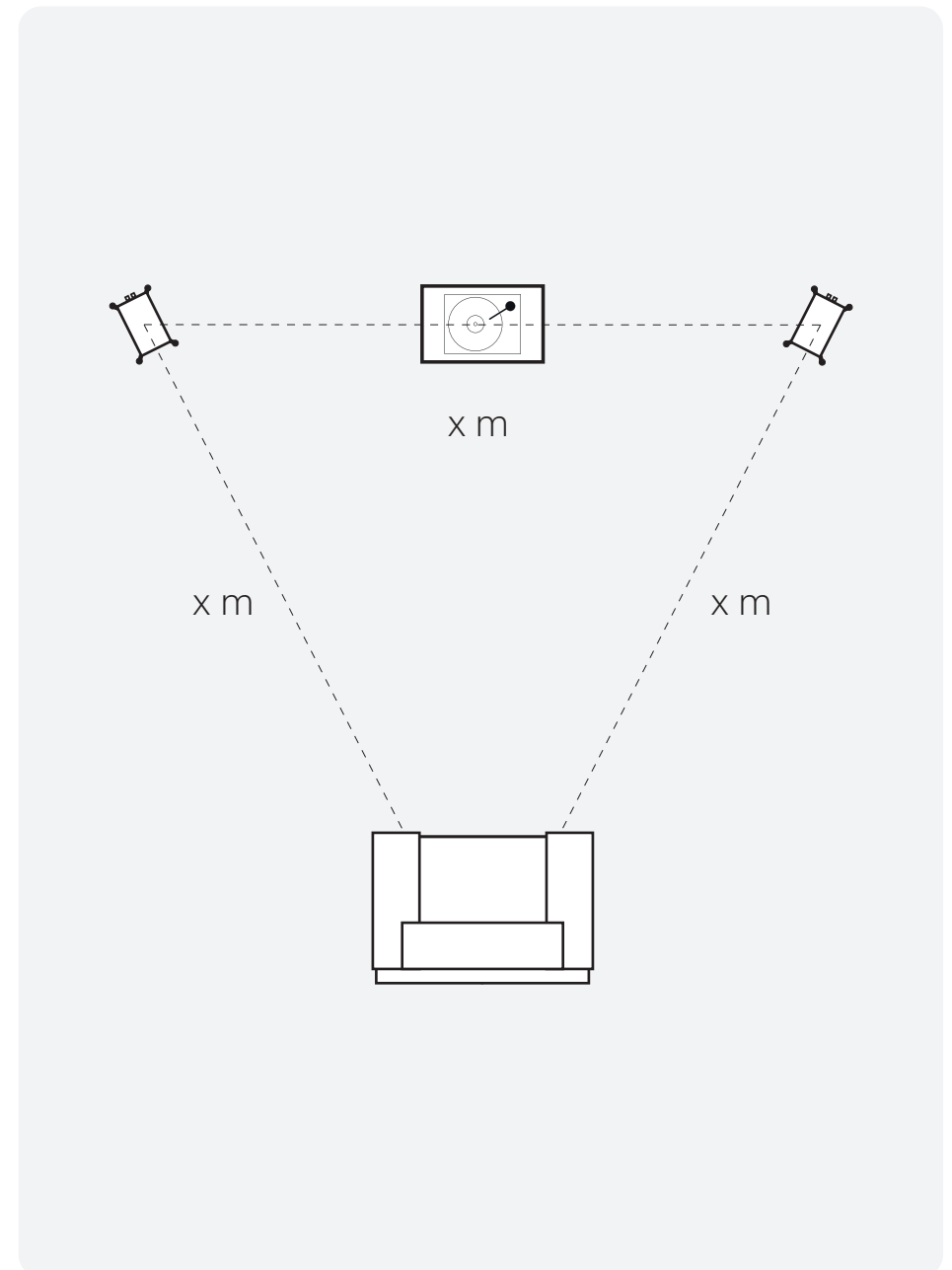

AV positioning

Refer to the illustration on the right for the recommended angles and positions of each loudspeaker in a surround sound system. Loudspeakers should be placed at the distances from the wall specified in the 2 Channel Positioning section on page 8. When a subwoofer is in use, the AV receiver’s crossover will redirect low frequency content to the subwoofer, which may permit positioning the loudspeakers closer to the wall. Experimentation is advised to achieve optimal performance.

NOTE: Images are for illustrative purposes only.

- For a 5.1 system, position the surround speakers at location (A).
- For a 7.1 system, position the side speakers at (B) and the rear speakers at (C).

Modern film soundtracks contain substantial low frequency energy, including a dedicated LFE (Low Frequency Effects) channel intended specifically for subwoofers. Many of these frequencies fall below the operating range of typical loudspeakers and therefore, the use of a subwoofer or multiple is recommended.

Once the loudspeakers are installed, run the AV receiver’s automatic setup or calibration routine. This process typically uses a supplied microphone placed at the primary listening position and will configure channel levels, distances, and time alignment.

When a subwoofer is present, ensure that the AV receiver has assigned all loudspeakers the ‘Small’ setting. This ensures that low frequency content is correctly directed to the subwoofer. You may also adjust the crossover frequency, which determines the transition point between the loudspeakers and the subwoofer. For example, with an 80 Hz crossover, frequencies above 80 Hz are sent to the loudspeakers, while frequencies below 80 Hz are directed to the subwoofer.

As a starting point, we would recommend using the following crossover settings for each speaker. As audio is subjective, so we recommend experimentation to find the best setting for your setup.

Radius 1	140 Hz
Radius 3	60 Hz
Radius On-Wall	100 Hz

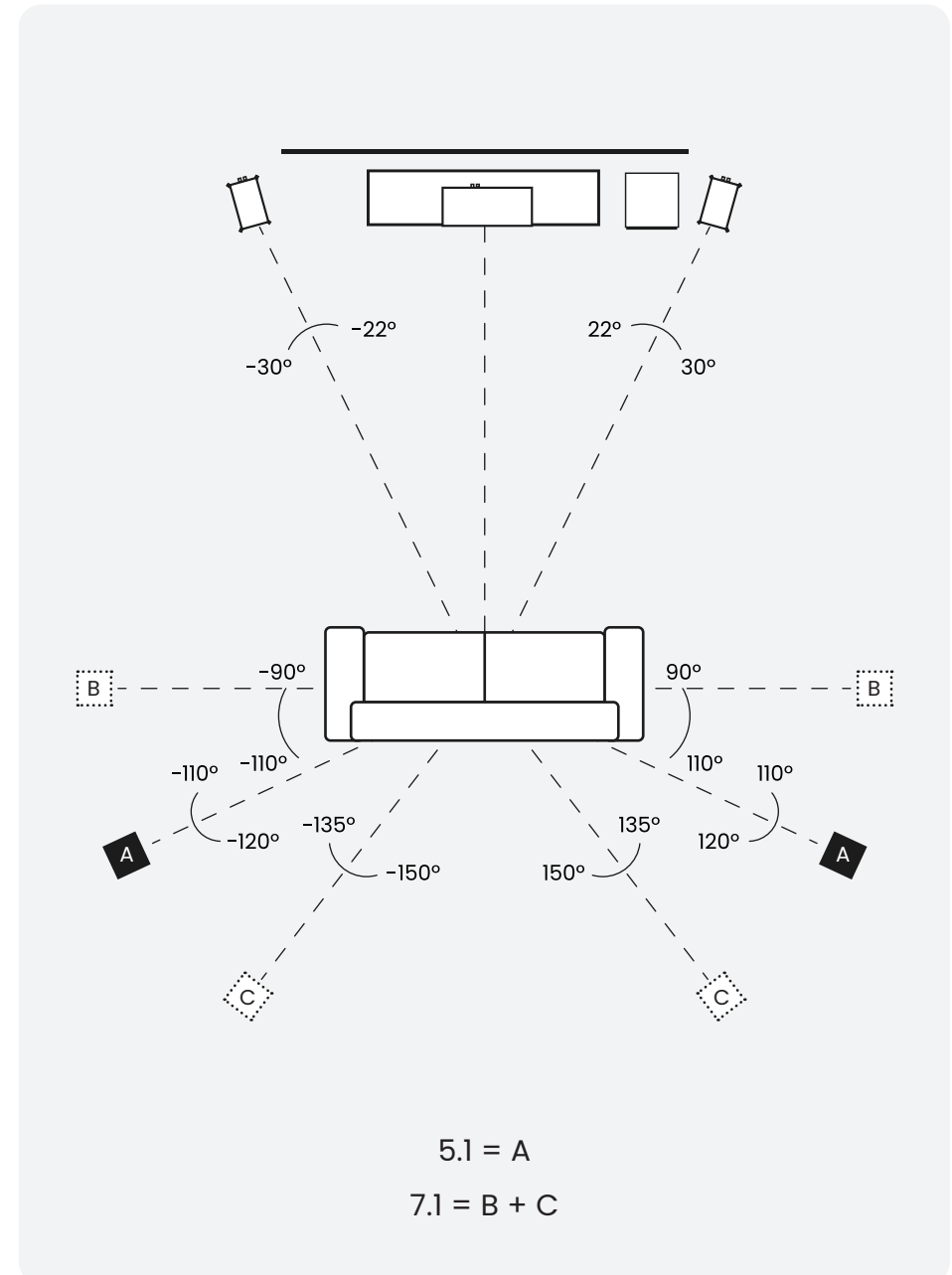

Dolby Atmos®

When arranging the overhead channels in a Dolby Atmos® system, we would recommend using our Creator Series in-ceiling speakers.

Please see the diagram on the right for ideal positioning of 2 or 4 Dolby Atmos® loudspeaker setups. Typically, these would be in line with the front left and right loudspeakers.

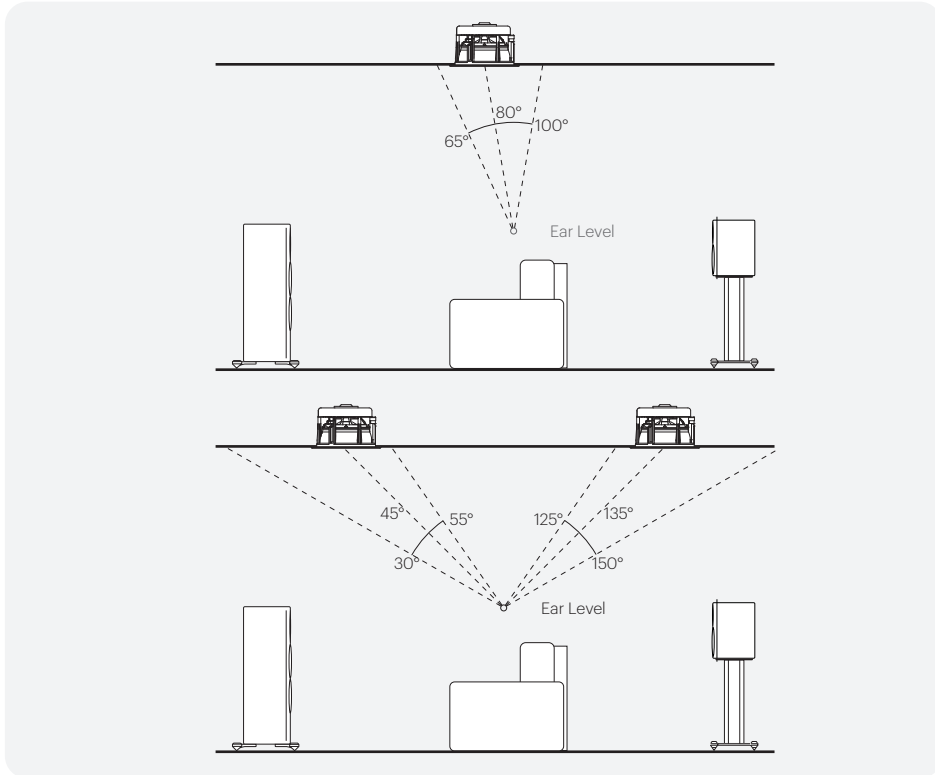

Fixing the Radius 1 or 3 4G to a wall

The Radius 1 and Radius 3 speakers can be mounted using our MASM or FIX M wall brackets (sold separately). These mounts attach using the 1/4" UNC threaded insert located on the rear of each speaker.

Fixing the Radius On-Wall 4G to a wall

The Radius On-Wall 4G comes with keyhole inserts that hook onto screws fixed in the wall. They can be mounted in vertical or horizontal orientation, perfect for front Left - Centre - Right duties. We do not supply wall fixing screws and plugs with the Radius On-Wall 4G. Please use suitable fixings for the type of wall construction the speaker will be fixed to.

To fix your Radius On-Wall 4G speaker to the wall, we would recommend using the wall fixing template enclosed within the packaging carton.

The grille badge is located for vertical orientation by default but can be moved for horizontal orientation, it has a peg locator that pushes into the grille.

CAUTION: Always determine where the Radius On-Wall 4G will be fixed and the structure of the wall. For safety reasons, if unsure of your ability to provide a secure and safe fixing, do not attempt to fix these speakers to a wall. Instead, please obtain the services of a competent and qualified trades person.

CAUTION: Ensure that water pipes or electricity cables do not run behind where the speaker is going to be secured. Work from secure steps and avoid trailing wires.

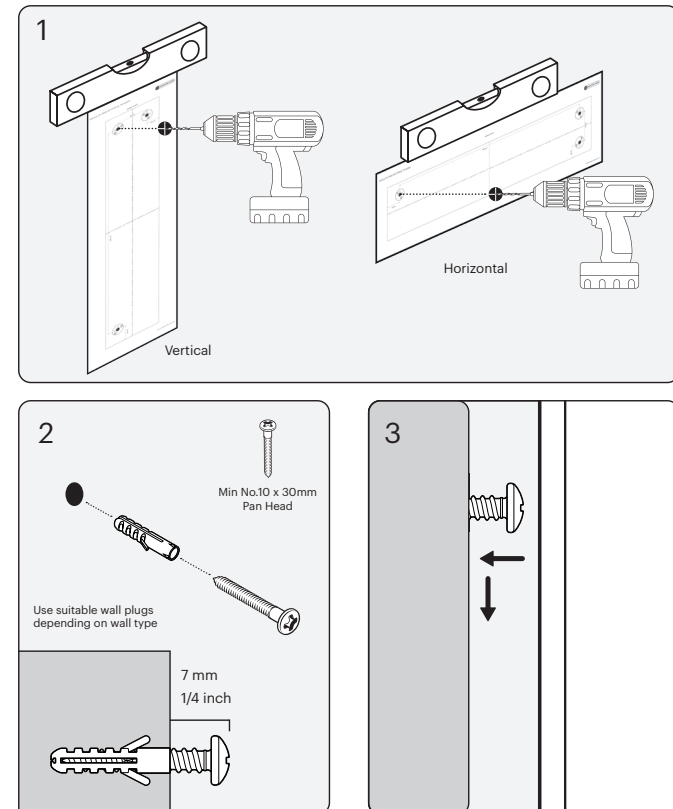

Each Radius 4G speaker is fitted with a single pair of high quality terminals for connecting to your amplifier of choice, supporting bare wire, banana plugs (4mm), and spade connectors (6–8 mm).

For bare wire connections, unscrew the top of the binding post to reveal the through hole in the threaded section. Insert the stripped cable through the hole and tighten the post securely.

Warning: Ensure no stray strands of wire touch across the terminals as this can cause damage to your amplifier.

Banana plugs can be inserted directly into the flat circular face of the terminal. The terminals are supplied with small plastic safety caps that must be removed before use. As banana plugs protrude from the rear of the speaker, they cannot be used with the Radius On-Wall 4G when the speaker is mounted.

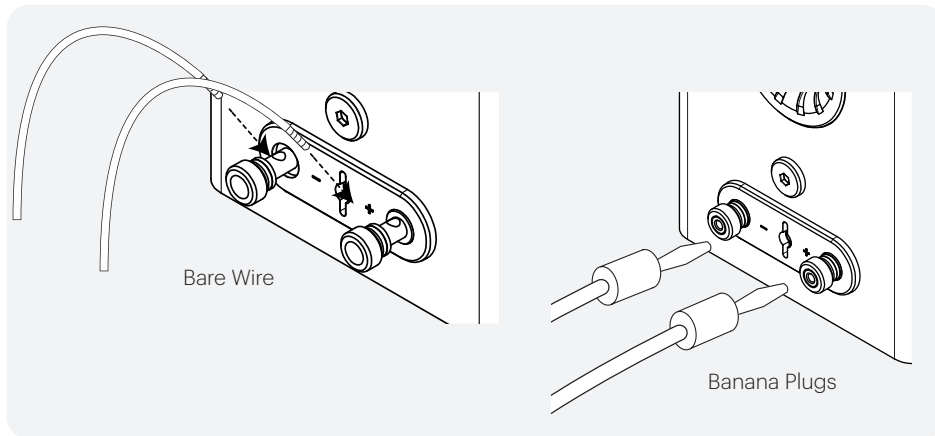

Running-in your loudspeakers

Run your loudspeakers in by playing music or movies at low-mid listening levels for approximately 50-70 hours play time. You may find the sound will continue to improve even after the 70 hour mark.

This can be done naturally over time: like a fine wine the performance will improve with age.

Alternatively, if you wish to run the loudspeakers continuously on loop, you can decrease the audible volume/presence by placing the loudspeakers face-to-face ensuring the drivers/tweeters are directly aligned and as close as possible. Then connect the amplifier to your loudspeakers so that in phase: positive to positive and negative to negative (red to red and black to black), and the other loudspeaker out of phase: positive to negative and negative to positive inputs on the loudspeaker.

Port Bungs (Radius 3 4G Only)

The Radius 3 4G speakers are supplied with foam port bungs that can be inserted into the rear ports when bass output that is stronger than desired. This is particularly helpful when the speakers are positioned close to a rear wall or corner, resulting in the low frequency response becoming exaggerated or "boomy".

Fitting the port bungs reduces low frequency energy around the port tuning frequency, which is the range most likely to excite room modes. This adjustment does not reduce the speaker's overall bass extension, but it can moderate excessive bass emphasis, improving clarity and control in rooms where low frequency build up occurs.

As audio is very subjective to personal tastes and every room is different, we recommend experimenting with the port bungs installed or removed to achieve the balance that best suits your setup.

Upkeep of cabinets

The finish of the cabinet can be maintained by regular dusting using a soft cloth or micro fibre/lint-free cloth. If a high gloss finish needs to be revived a high-quality, non-abrasive, automotive wax or polish can be used. The drive units should only be cleaned with a damp cloth if more than normal dusting is required.

Never use solvents or aggressive cleaning/polishing agents on your Radius Series 4G loudspeakers. When in doubt, test the cleaning product on an inconspicuous area on the cabinet and let it sit for several days before committing to its use on visible portions of the cabinet.

Retention Bolt adjustment

The new Radius Series 4G has a bolt-through driver fixing to reduce cabinet colouration. Each bolt acts as a rigid brace, but also removes the need for conventional driver fixings as well, effectively decoupling the driver and front baffle to eliminate a further source of resonance.

NOTE: Should this bolt become loose over time, or has worked loose during transit, then please use the supplied allen key to tighten the bolt back up. This only needs to be a quarter turn after the strain has been taken by the bolt.

In the unlikely event that there is a defect with this product, your Radius Series 4G loudspeakers are covered by the Monitor Audio manufacturer's 5-year warranty, provided that the product was supplied by an authorised Monitor Audio retailer.

For the period of cover please refer to the product page on our website at monitoraudio.com

Register your Radius Series 4G speakers

Register your speakers using the QR code
or visit monitoraudio.com/registration



Specifications

Specification	Radius 1	Radius 3	Radius On-Wall
System Format	2-Way	2-Way	2-Way
Frequency Response, In-Room (-6dB)	100 Hz - 35 kHz	44 Hz - 25 kHz	69 Hz - 25 kHz
Sensitivity (2.83 Vrms @ 1m, Free-Field)	82 dB	84 dB	N/A
Sensitivity (2.83 Vrms @ 1m, Installed)	N/A	N/A	90 dB
Nominal Impedance	8 Ohms	8 Ohms	8 Ohms
Minimum Impedance (20Hz to 20kHz)	3.8 Ohms @ 950Hz	4.0 Ohms @ 250 Hz	4.4 Ohms @ 700Hz
Maximum Peak SPL (AES75, Z-weighted)	104 dB	107 dB	114 dB
Continuous Power Handling (CTA 426-B)	50 W	75 W	100 W
Recommended Amplifier Power (RMS, Music Signal)	50 - 100 W into 4 Ohms 25 - 50 W into 8 Ohms	75 - 150 W into 4 Ohms 40 - 75 W into 8 Ohms	100 - 200 W into 4 Ohms 50 - 100 W into 8 Ohms
Bass Alignment	Sealed	Ported	Ported
Port Tuning Frequency	N/A	53 Hz	62 Hz
Crossover Frequency	LF/HF: 3.2 kHz	LF/HF: 2.7 kHz	LF/HF: 2.3 kHz
Drive Unit Complement	1x 4" RST III bass-mid driver 1x 19mm C-CAM Gold Dome tweeter	1x 4 1/2" RST III bass-mid driver 1x 25mm C-CAM Gold Dome tweeter	2x 4 1/2" RST III bass-mid driver 1x 25mm C-CAM Gold Dome tweeter
Available Finishes	High Gloss Black Satin White	High Gloss Black Satin White	High Gloss Black Satin White
External Dimensions with all accessories fitted (H x W x D)	135 x 135 x 156 mm (5 5/16 x 5 5/16 x 6 1/8 ")	255 x 150 x 201 mm (10 1/16 x 5 7/8 x 7 15/16 ")	750 x 154 x 78 mm (29 1/2 x 6 1/16 x 3 1/16 ")
Weight (Product, Each)	1.8 kg (3 lb 15 oz)	3.7 kg (8 lb 3 oz)	6.4 kg (14 lb 2 oz)
Sold As	Pair	Pair	Single
Compatible MAG Brackets	MASM, FIX-M	FIX-M	N/A

Monitor Audio reserves the right to alter specifications without notice.

Monitor Audio Ltd.
24 Brook Road
Rayleigh, Essex
SS6 7XJ
England
Tel: +44 (0)1268 740580
Email: info@monitoraudio.group

monitoraudio.com